

Superficie de la Parcela 118. S4= 5.766,88 m²

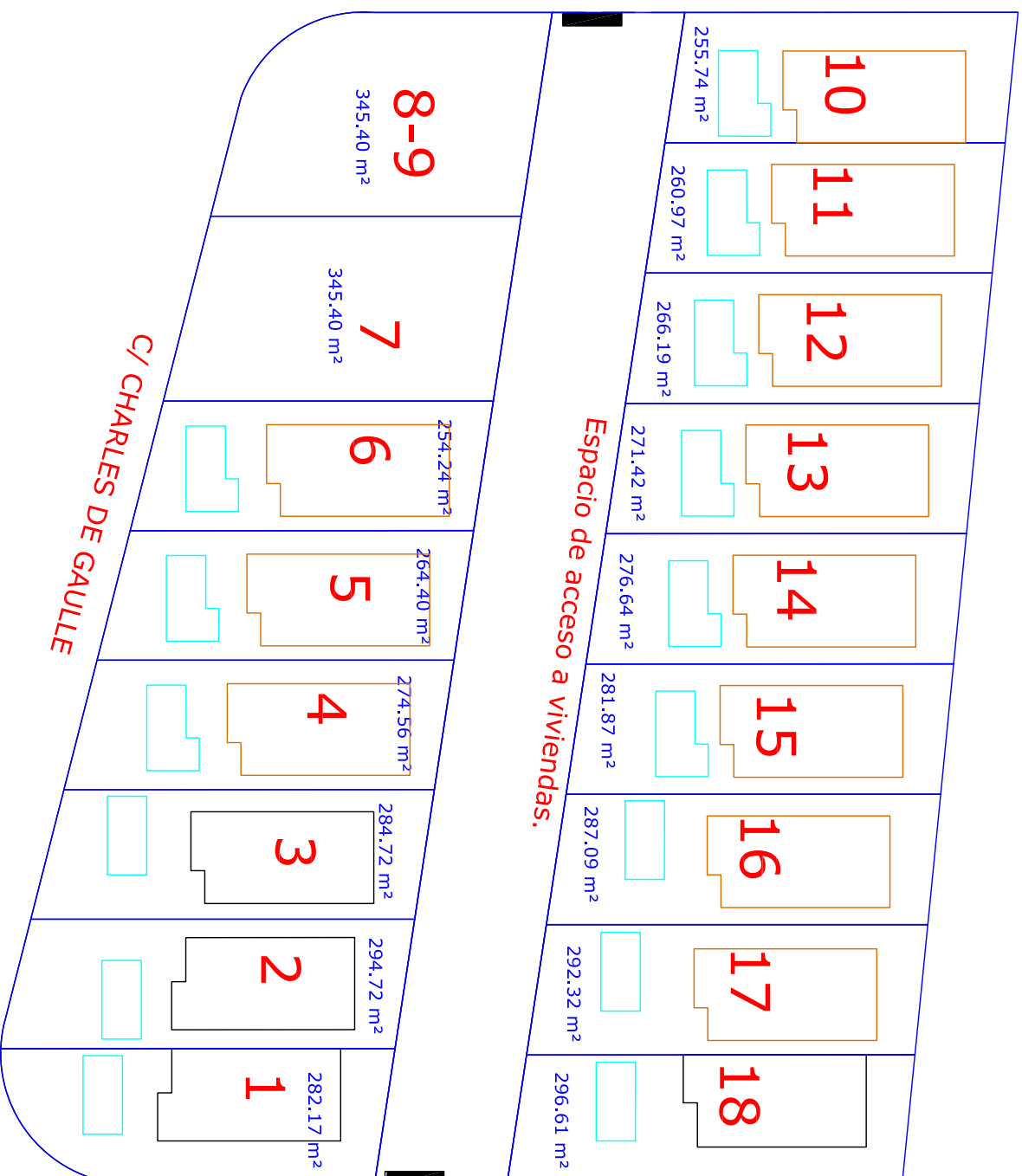

C/ WINSTON CHURCHILL, 4

Superficies Subparcelas Paraje	
01	282.17 m ²
02	294.72 m ²
03	284.72 m ²
04	274.56 m ²
05	264.40 m ²
06	254.24 m ²
07	345.40 m ²
08-09	345.40 m ²
10	255.74 m ²
11	260.97 m ²
12	266.19 m ²
13	271.42 m ²
14	279.64 m ²
15	281.87 m ²
16	287.09 m ²
17	292.32 m ²
18	296.61 m ²
Vial Interior	932.41 m ²
Total	5.766,88 m²